

## Emergency Phone Numbers

Medical, Fire or Police Emergency.....911  
Police Emergency.....1-877-851-6086  
Police Administration.....315-492-6422  
Park Office.....315-655-9620

## Facilities & Activities

194 Acres  
Picnic Areas, 1 Picnic Shelter  
Swings, Sand Boxes and Playing Fields  
Flush Toilets  
Hiking Trails  
Fishing

## Recreation

You may fish, hike, or picnic at Chittenango Falls. Two trails provide breathtaking views of the 167' falls. Observe the falls from the top, then follow the scenic, winding trail to the bottom of the gorge. Up above, the remains of a "turntable," a circular stone terrace, can be seen. Just large enough to turn a horse and buggy, this stone structure is evidence that the falls area has been a favorite spot for many years. The upper section of this trail also provides scenic views of the falls and surrounding countryside. Please observe safety precautions (including wearing appropriate footwear) as you explore this rugged, scenic park.

## Park Patron Alert

With the incidence of rabies on the rise in New York State, we ask that you report any abnormal animal behavior to the park office immediately. Animals in the park, including cats, are wild and should not be touched or fed.

Pets are welcome but must be properly licensed, and proof of current rabies vaccination must be presented upon entrance. Pets must be kept on a leash of no longer than 6 feet, and must never be left unattended.

## Carry In - Carry Out



This is a Carry-In, Carry-Out park. Please take all your garbage with you when you leave the park, and do your part to keep Chittenango Falls clean!

## Park History

The wise stewardship of early Central New Yorkers benefits all of us today as we enjoy the beautiful views at Chittenango Falls State Park. The Falls' early history was dominated by nearby factories and mills. In 1887, the property would have been sold to a gunpowder manufacturer if not for Mrs. Helen Lincklaen (Charles) Fairchild who intervened by asking friends to establish a fund to buy the scenic falls for use as a public park. Mrs. Fairchild was the third generation owner of Lorenzo located in Cazenovia, NY. Mrs. Fairchild created the Chittenango Falls Park Association which made numerous improvements to the park. An iron guard rail was installed at the dangerous drop-off point at the crest of the falls and, under this group's direction, a "turntable" was built in the area of present Rt. 13. This viewing area was a circular stone terrace, just large enough to turn a horse and buggy. It was a favorite spot for picnickers and photographers, as it was the only area in the park that could offer a close-up view of the falls. When Route 13 was relocated to this side, its excavation destroyed most remnants of the turntable.

Camping, picnics, champagne and "dancing on the green" to the newly invented gramophone were the main activities in the park in the late 1890's and early 1900's. The Chittenango Falls Association ran the park until 1922 when it became a state park.

## Geology

Two geology stories are clearly visible at the park, one having taken place millions of years ago, and the other just a few thousand years ago. 400 million years ago under a shallow salty sea, layers of limestone and shale were laid down. These layers contain the fossil remains of creatures which lived during a long period of sedimentation and rock formation. Early forms of marine algae, sponges, corals and mollusks are just a few of the groups visible along rocky trails, outcrops and exposed bedrock stream beds in the Chittenango Falls area.

Many Central New York State parks are built around unique glacially created features - glacial plunge basin and kettle lakes, eskers, or, in the case of Chittenango Falls, a majestic waterfall. The 167' cascade is the main feature of this unique state park. On its way to Oneida Lake, the Chittenango Creek descends the north margin of the

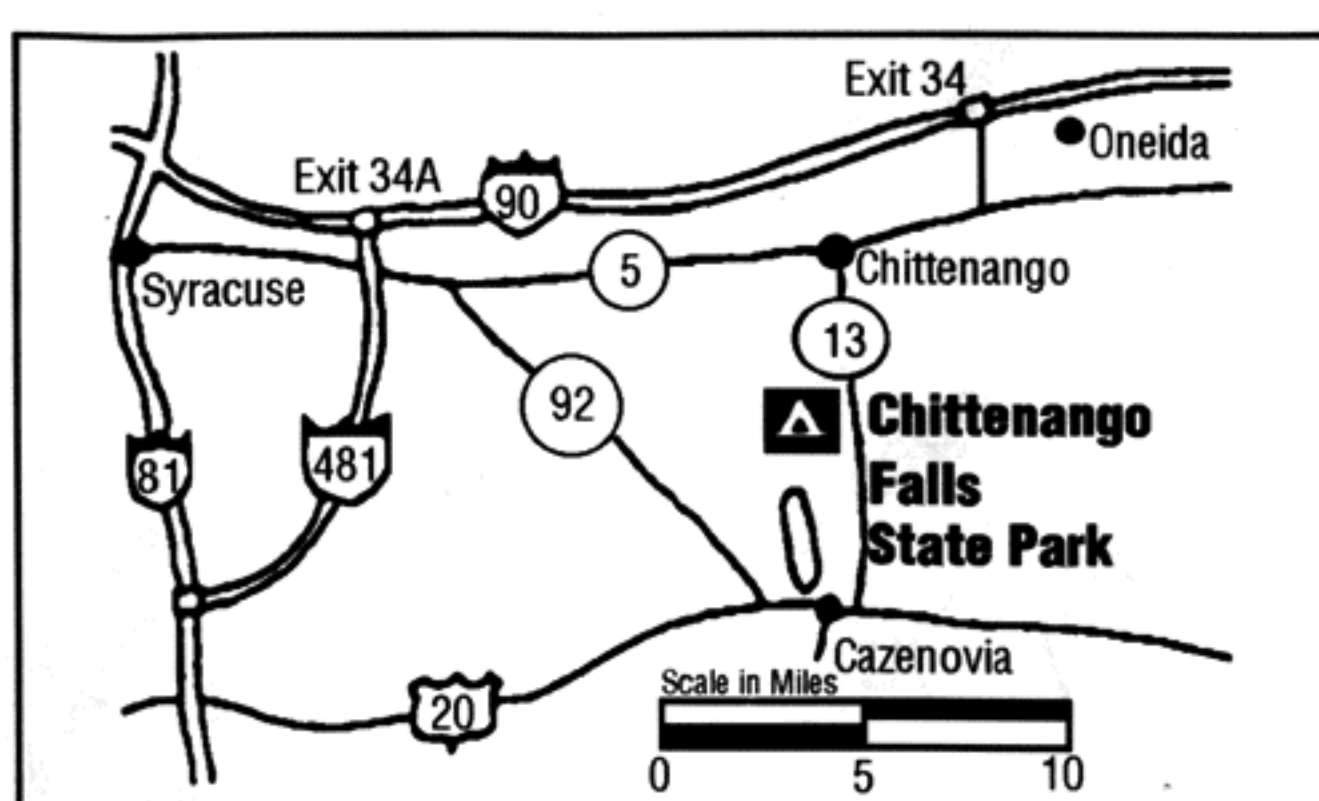

## Directions

**BUFFALO-ROCHESTER-SYRACUSE:** Thruway (I-90) East to Exit 34A; Rt. 481 South to Fayetteville Exit, then Rt. 5 East to Rt. 13 South to park entrance.

**NEW YORK and ALBANY:** Thruway (I-90) West to Exit 34 (Canastota); Rt. 13 South to park entrance.



## Accessibility

Accessible parking spaces, comfort stations, picnic areas, and a falls overlook area are available within the park and are noted with a ♿ icon. Please contact the park office for specific information.

## Reservations

Reservations for all New York State Park Campgrounds are available by calling the New York State Camping Reservation System at 1-800-456-CAMP, or online at [www.ReserveAmerica.com](http://www.ReserveAmerica.com)

Regional Office....315-492-1756

[www.nysparks.state.ny.us/](http://www.nysparks.state.ny.us/)



State of New York  
Eliot Spitzer, Governor  
Office of Parks,  
Recreation, and Historic Preservation  
Carol Ash, Commissioner  
An Equal Opportunity/Affirmative Action Agency

Produced by JMF Publishing 30 Burr Ave, New York Mills, NY 13417  
as a service for visitors to the Central Region of the New York State  
Office of Parks, Recreation and Historic Preservation  
For sponsorship information call 315-768-7137

Allegheny Plateau through a narrow valley, which constricts into a gorge where Chittenango Falls descends a series of resistant rock layers.

The falls results from a glacial diversion of the stream over a wide terrace of (Onondaga) limestone. Three stages of gorge development may be seen in the park, the earlier two having been filled in by re-advances of the ice. The oldest gorge section, which branches off at nearly right angles below the falls, was probably eroded during an interglacial period of many thousands of years. The most recent gorge is 200' long, while the oldest buried one extends approximately 1800'. The last ice age ended approximately 12,000 years ago.

## Conservation: LET'S PRESERVE OUR LANDSCAPE HERITAGE

Although small in acreage, Chittenango Falls State Park ranks high in biodiversity. Rich and abundant plant and wildlife communities occupy numerous natural habitats. Think about the diverse natural communities which can be viewed just from the overlook. From the rigorous environment of the watery ledges' nooks and crannies, to the rushing stream and streamside woodlands to the upland woodlands and meadows, more than 170 species of vascular plants may be found, while approximately 100 species of birds call the park home at least some part of the year.

In the midst of this magnificent natural environment are harbored several unique and significant species. We can protect their existence and the special beauty of Chittenango Falls by leaving all the park habitats as they are found and by reminding others of the reasons for the following strict regulation: **VISITORS MUST NOT REMOVE OR DISTURB ANY PLANTS, WILDLIFE, OR REMOVE FOSSILS AND ROCKS FROM THE PARK. IT IS ILLEGAL TO DO SO.**

# Chittenango Falls STATE PARK



2300 Rathbun Road  
Cazenovia, NY 13035  
Park Office: (315) 655-9620  
Fax: (315) 655-2686



## Exploring The Park

Stop first near the top of the falls where the 167' waterfall cascades over a series of limestone terraces. A scenic, but rugged, trail leads to the bridge at the bottom of the gorge. Halfway down is a resting bench from which there is a "camera-perfect" view of the falls. Continue down this trail, noting the great variety of interesting ferns, wildflowers and shrubs which grow along the steps and ledges. From the bridge, enjoy the spectacular view of the falls in one direction and the view of scenic Chittenango Creek in the other. You may be able to spot the remains of the viewing "turntable" built in the late 1800's. The upper section of this trail also provides scenic views of the falls. Those desiring longer treks should follow the trail which retraces the old path of Route 13, when it was a wooden plank road and was located on the west side of the falls.

The park is especially attractive in fall when colors are at their peak and in springtime when the various shades of green frame the falls. April is usually the time to view the heaviest flow at the falls. Spring through fall, birdwatchers will want to check out the swallows and Cedar Waxwings which are easily seen from the overlook. Request a bird checklist at the office or ticket booth to better enjoy your park visit.

## Good Manners

**Be respectful** of others by keeping noise to a minimum level and keeping your picnic area clean, and litter-free. Litter leads to more litter; don't be the first to drop it.

**It is illegal** to collect anything on state lands. Plants, fossils, rocks, and animals are important parts of the park experience. Please leave them there for everyone's enjoyment and your safety.

Family Owned & Operated Since 1964

**Alpin Haus**

Best Brands Best Selection Best Prices

**One of America's Largest RV Dealers**  
**Voted 2006 RVDA National Top Quality Dealer of the Year**



Motorhomes  
 Travel Trailers  
 Fifth Wheels  
 Pop-Ups  
 Truck Campers

**CAMPING WORLD**  
 800-828-4413

**Camping World on Premises at our Amsterdam Location!**

Three locations to serve your recreation needs:  
 I-90 Exit 27 - Route 5S West - Amsterdam, NY  
 I-87 Exit 16 - Saratoga (Wilton), NY  
 I-87 Exit 9W - 103 Sitterly Rd - Clifton Park, NY  
 (Between the Northway and Boscov's)

Toll Free (888) 431-0687  
 www.alpinhaus.com

**EVERYBODY LOVES...**

**WATER SAFARI**  
 ENCHANTED FOREST

31 Heated Water Rides  
 Over 50 Rides & Attractions  
 Buy & Print Tickets Online

RT. 28 Old Forge (315) 369-6145  
 www.watersafari.com

**MADISON County**

spend the day, stay the night  
 Hiking, Hunting, History, Outdoor Adventure, Camping, Fishing, Fun on the Farm, Antiquing, Dining, Shopping, and so much more

Your outdoor adventure in Madison County has only just begun. Call us for a free travel guide featuring the best of Central New York.

1-800-684-7320 or www.madisontourism.com

The best of Central New York is only a short drive away in Madison County.

**Central New York Region**

**THE ABILITY TO SAFELY GO WHERE MOST MAPS DON'T. IT'S WHAT MAKES A SUBARU, A SUBARU.**

subaru.com SUBARU

**P&C**

Food & Pharmacy  
 Your kind of store.™

Shop P&C locations across New York State for all your camping supplies.

Town & Country Plaza, Cazenovia 315-655-4565

**New York's Largest Canoe & Kayak Dealer**

Over 1000 Canoes & Kayaks in Stock!  
 Wilderness Systems • Bell • We no nah Perception • Necky • Dagger • Vermont Canoe Old Town • Liquidlogic • Eddyline and more!

Canoe & Kayak Sales & Rentals

Two Adirondack Locations  
 Rt. 28, Inlet • (315) 357-6672  
 Rt. 28, Old Forge • (315) 369-6672

Mountainman Outdoor Supply Company  
 www.mountainmanoutdoors.com

Trail E ends at Rathbun Road

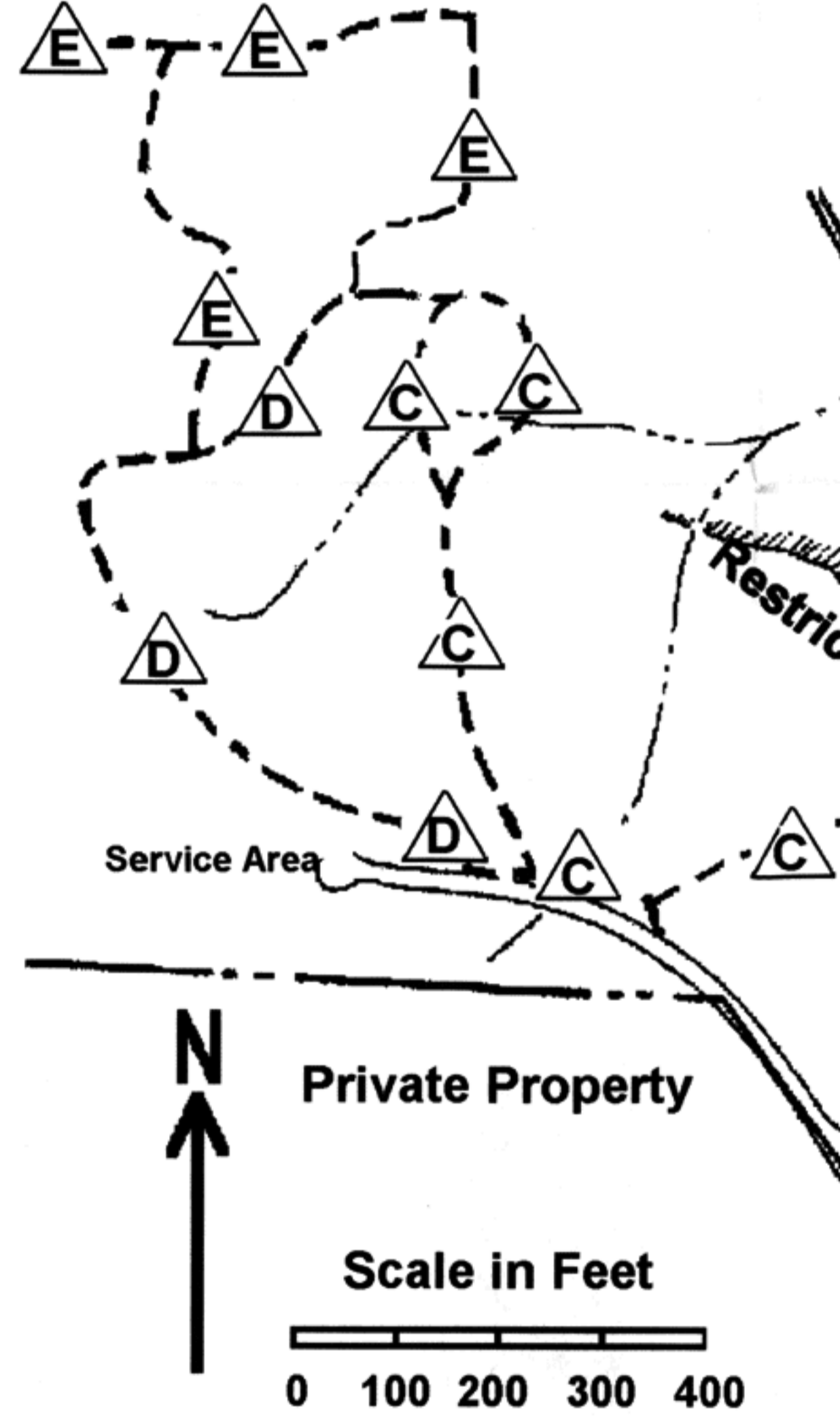

# Chittenango Falls State Park

## Trail Locator & Mileage

- A Gorge Trail.....0.25 Red Markers
- B Creekside.....0.17 Blue Markers
- C Chips Trail.....0.85 Yellow Markers
- D Meadow Trail.....0.52 Green Markers
- E Meadow Ext. Trail.....0.60 Orange Markers

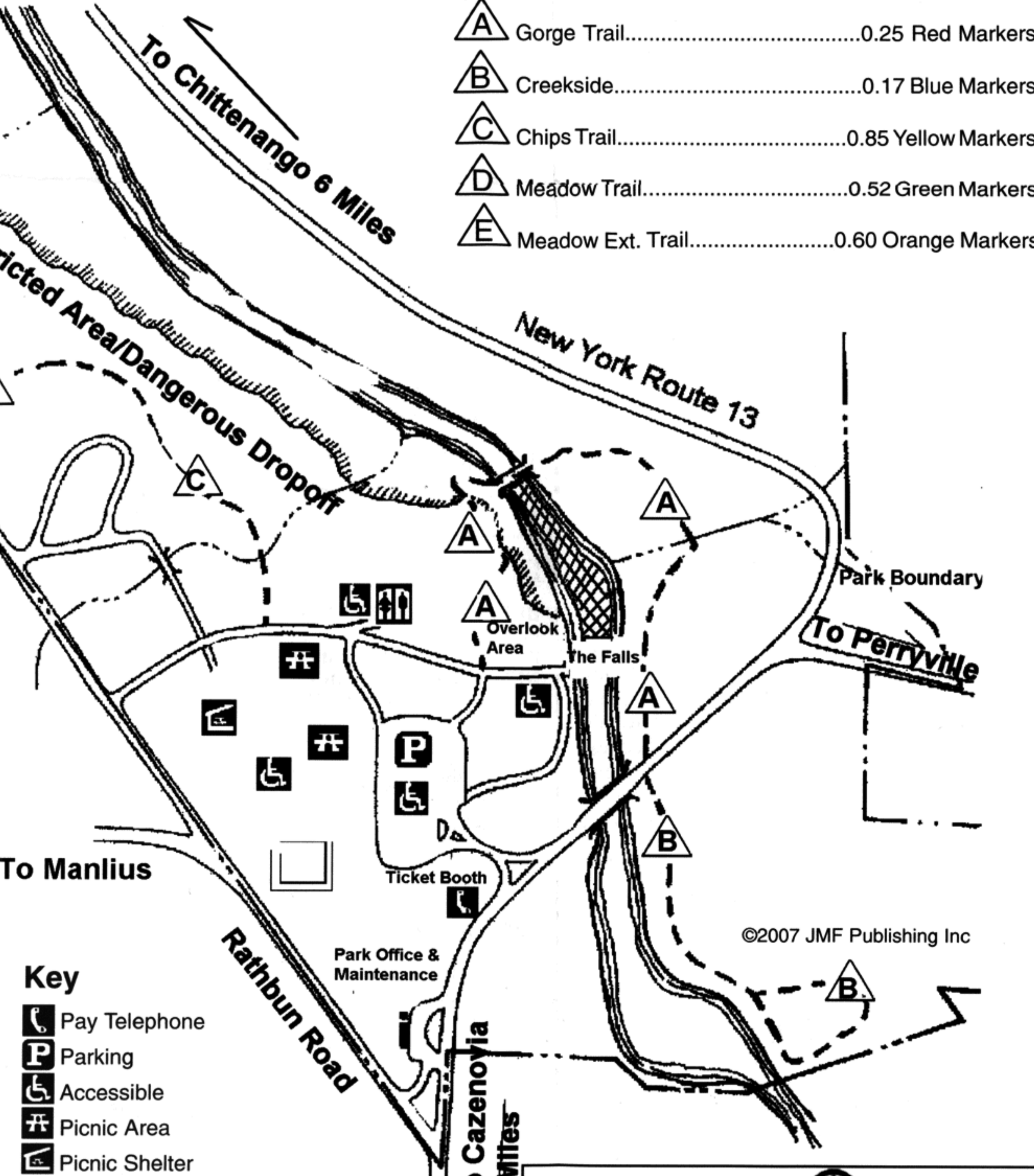

- Key**
- ☎ Pay Telephone
  - P Parking
  - ♿ Accessible
  - # Picnic Area
  - ☒ Picnic Shelter
  - ♿ Comfort Station
  - ⊞ Ball Field
  - Nature Trail
  - Waterway
  - ⊞ Restricted Area/Entrance Prohibited

**VISIT THE 1000 ISLANDS**

**Uncle Sam Boat Tours**

- Lunch & Dinner Cruises
- 2 ¼ hour and 1 Hour Sightseeing Cruises
- Singer Castle Tour
- Unlimited Stops at Boldt Castle
- Group Rates Available

Toll Free 1-800-253-9229

All tours depart from  
 47 James St., Alexandria Bay, NY 13607  
 315-482-2611

Capt. C.S. Thomson: 1876-1967 Capt. A. Gaham Thomson: 1919-1969  
 Capt. Ronald G. Thomson: General Manager

**INTERNATIONAL PAPER**

This brochure is printed on paper proudly produced by International Paper's Ticonderoga Mill... made from trees harvested in working Adirondack forests that are managed responsibly to provide recreation, open space, environmental, and economic benefits for today and for future generations.